

Directions from the autobahn A3 (Nuremberg – Passau), Exit "Universität" to the University, Chair of Professor Spoerer

Leave the autobahn at the exit "Universität".

If you come from Nuremberg, Munich or Hof, turn right at the T-junction into the "Franz-Josef-Strauß-Allee" and then right again at the next traffic light. You will be on "Galgenbergstraße" and have to pass the next two traffic lights straight on. At the third traffic lights, turn left into "Albertus-Magnus-Straße" (be careful, you are only allowed to drive at 30 km/h here).

Right after entering the tunnel, turn left twice into the carpark.

If you come from Passau, turn right into "Galgenbergstraße". Drive straight at the next traffic lights and turn left into Albertus-Magnus-Straße at the following traffic lights. Proceed as explained above.

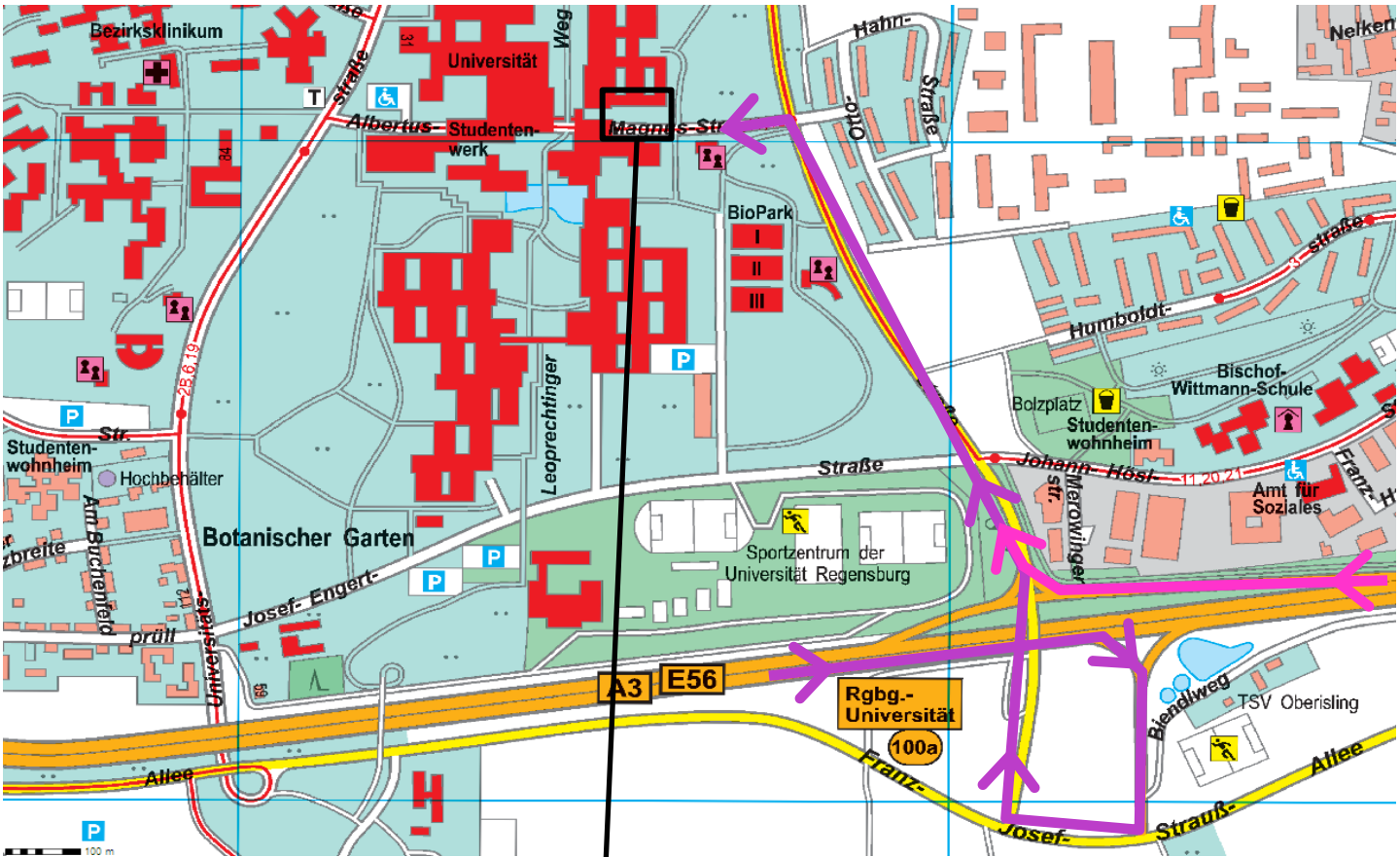

Leave the parking level and cross the road. Now enter the building "Philosophie / Theologie" and turn right into the corridor – then enter the fourth door to your right.

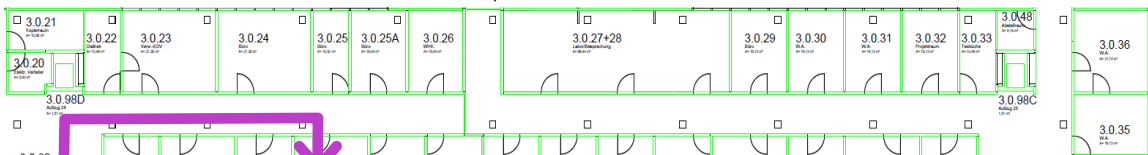

Albertus-Magnus-Straße

Tunnel

driveway parking garage

Professor Mark Spoerer

Chair for Economic and Social History
office: PT 3.0.09

phone: +49 941 943-5750

fax: +49 941 943-81-5750

e-mail: Mark.Spoerer@ur.de

Secretary: +49 941 943-5751

e-mail: Sekretariat.WiSo@ur.de

Universitätsstraße 31, D-93053 Regensburg

internet: <http://esh.ur.de>