

Directions from the train station to the Chair of Prof. Spoerer

Leave the train station and face the Regensburg Arcaden (shopping mall).

Leave the glass-transition by turning left right before entering the shopping mall. You will find yourself at the bus stop "Galgenbergbrücke".

At the bus stop, take bus line 6 or C6 (it will read "Klinikum" or "Universität" on its top). Drive until you reach "Otto-Hahn-Straße".

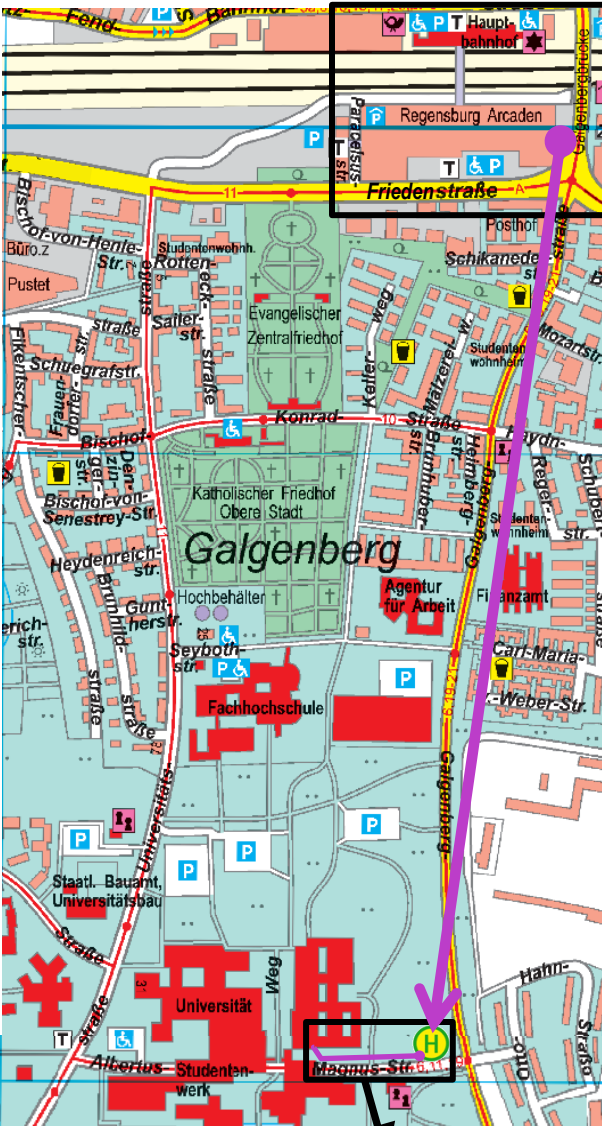

Professor Mark Spoerer

Chair for Economic and Social History
office: PT 3.0.09

phone: +49 941 943-5750

fax: +49 941 943-81-5750

e-mail: Mark.Spoerer@ur.de

Secretary: +49 941 943-5751

fax: +49 941 943-81-5751

e-mail: Sekretariat.WiSo@ur.de

Universitätsstraße 31, D-93053 Regensburg
internet: <http://esh.ur.de>

At the bus station, turn left and walk for about 80 meters along the "Albertus-Magnus-Straße". Enter the second door to your right (right before the tunnel).

You will find yourself in the building "Philosophie/Theologie". Now take the first corridor to your right. The office will be behind the fourth door on your right hand side (PT 3.0.9).

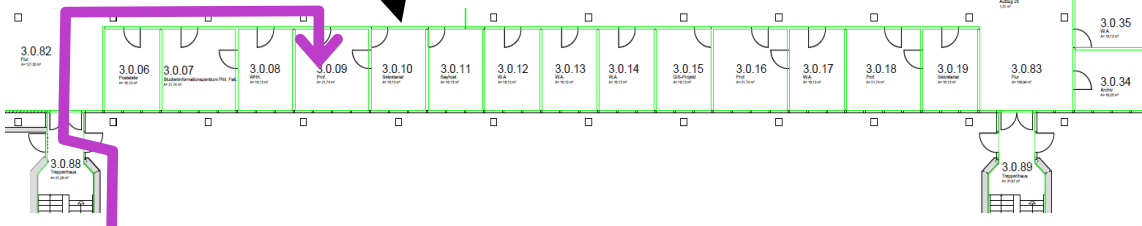

Tunnel

Albertus-Magnus-Straße

